

ADAL HOME PTY LTD

56 Maple Crescent, Hoppers Crossing 3029
1800 ADALHOME (1800 232 546)
www.adalhome.com.au - Fanpage / Youtube
info@adalhome.com.au



Installation Manual

Content

Introduction	3
Prepare	4
Coating	5
Cutting	6
Applying Glue	6
Tape on	7
Fixtures	7

Introduction

Adal Stone® product line is one of the most exciting innovative building materials across the globe in modern history. They are finely thin stone layers with durable polyester resin and glass fibre on the back, which are just sufficient to show the beautiful native stone veins while tremendously help save the stone supplies for the Earth.

They are lightweight, finely thin, extremely flexible and very safe in usage. As a result, you can apply them at various decorative places which were impossible for traditional heavy stone slabs such as curved feature wall, kitchen and furniture, and on diverse base textures such as aluminium, wood, concrete and glass.

Adal Home® proudly provide Adal Stone® in the Australian market, which will open a whole new wide range of beautiful, durable and well-priced decorative stones. More importantly, we wish to create a new green habit of using Adal Stone® to save the environment.

This exclusive **Adal Stone® Installation** Manual will guide you step-by-step through a very easy installation process.



Installation Manual



Prepare

Material & tools



1. Adal Stone sheets
2. Stone protector liquid
3. Glue/Adhesive
4. Roller / brush
5. Wipe
6. Sanding papers
7. Cutting tools
8. Other tools
9. Safety equipments

Installation Manual



Cleaning applied surfaces

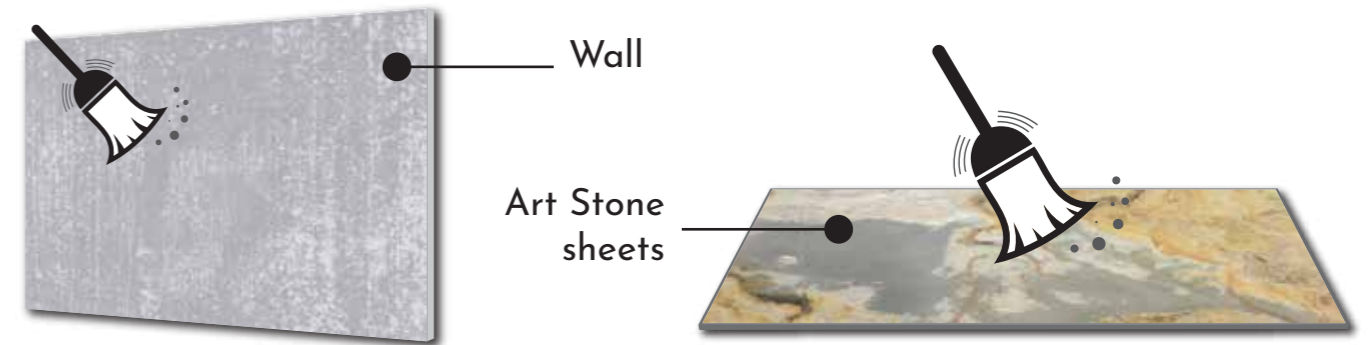

Cleaning walls and Art Stone sheets by broom, water or wipe. Make sure that all of the surfaces are dry before doing next steps.

Coating

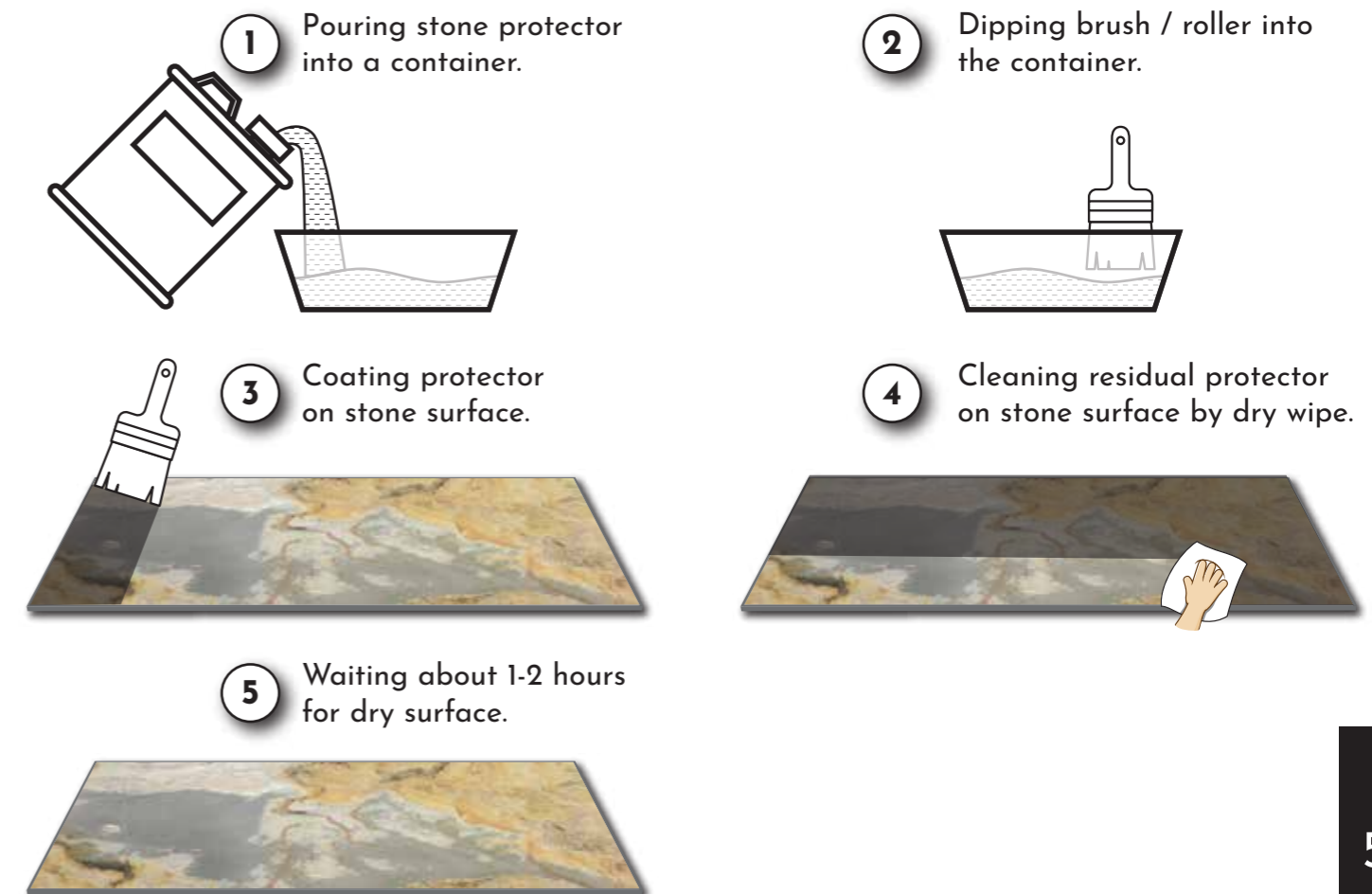

Installation Manual



Cutting

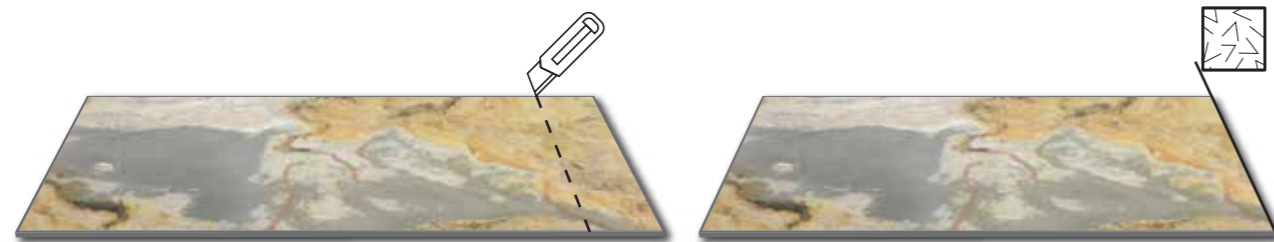

1 Cutting stone sheet to size needed.

2 Sanding the newly trimmed edges for smoothness.

Note: You can use other cutting tools (e.g saw, scissors, ect.) for this step.

Applying Glue

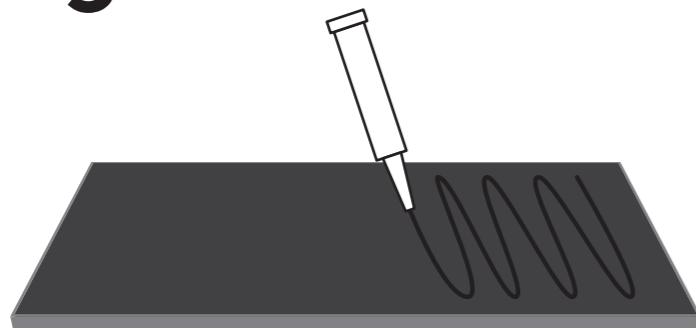

Or

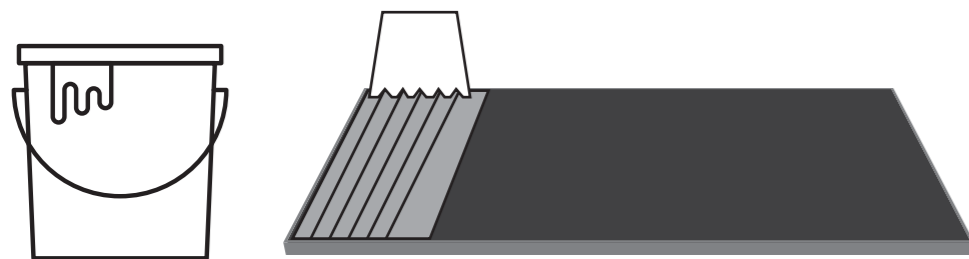

Applying glue/adhesive directly from a tube or by notched trowel. The glue should be stretched over full of sheet area. With multi-component glue/adhesive, you should mix them before using.

Installation Manual



Tape on

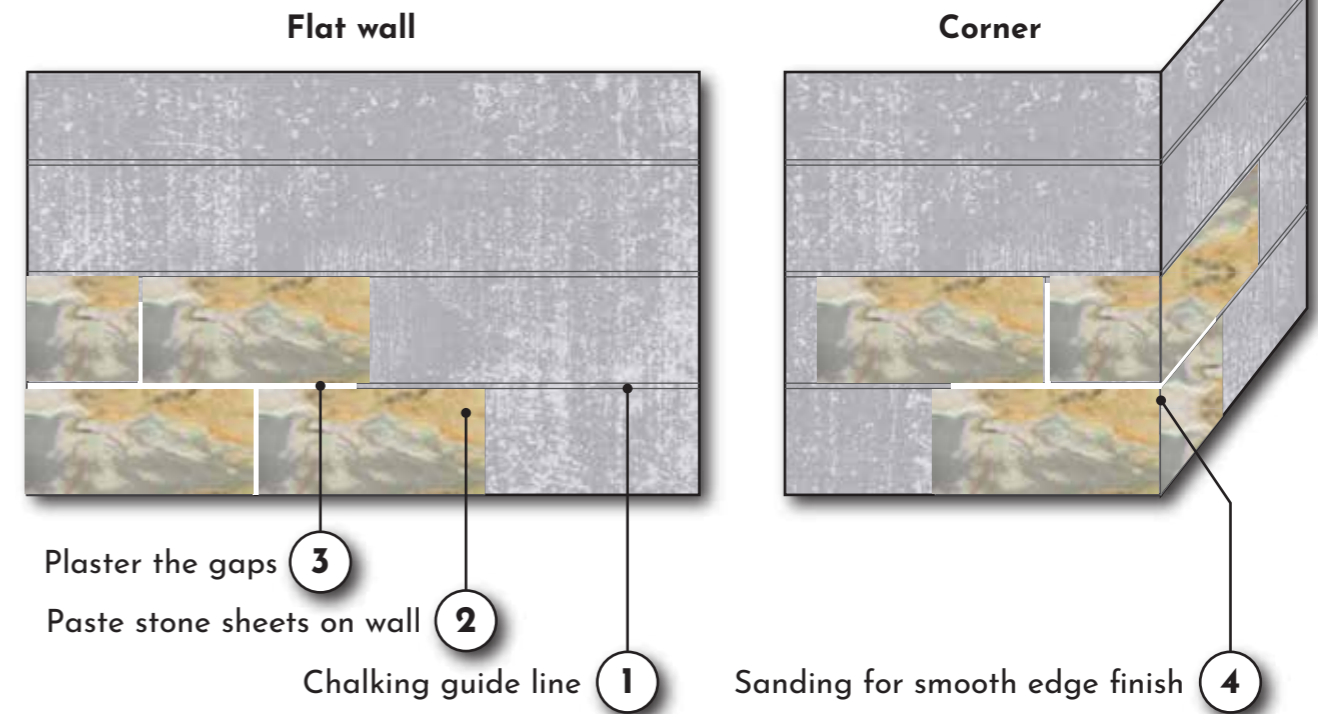

Note: Thickness of gaps between tiles bases on your idea. Essentially they can be zero to have straight-lined finish.

Fixtures

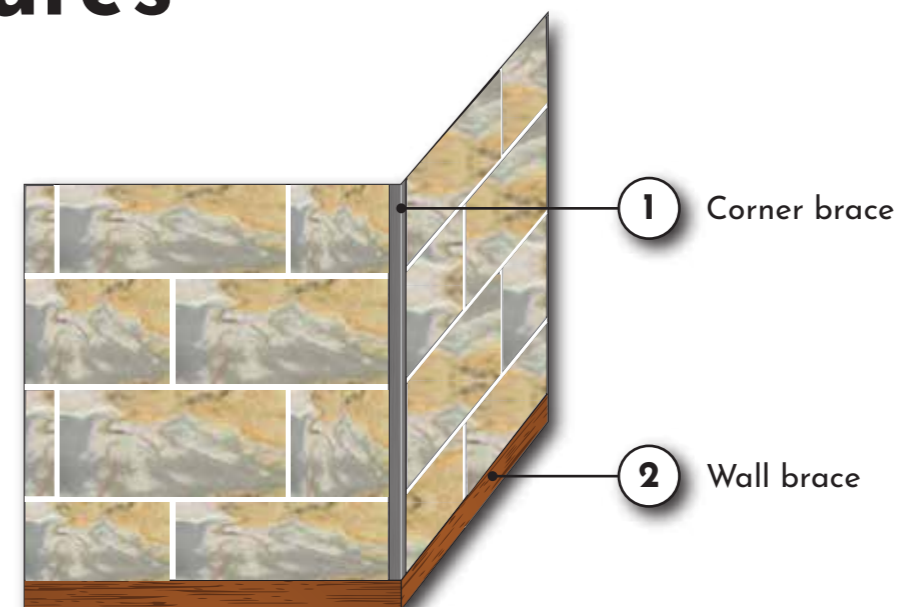

Note: Various fixtures can be applied with Adal Stone. Each of them will need a different installation way.